

*jura*<sup>®</sup>



E8/E80/E800 – Quick Reference Guide

## E8/E80/E800 – Quick Reference Guide



These short instructions do not replace the ‘E8/E80/E800 Instructions for Use’. Make sure you read and observe the safety information and warnings first in order to avoid hazards.

### Rinsing the machine



You can start coffee system rinsing manually at any time.

- ▶ Place a receptacle under the coffee spout.
- ▶ Press the ‘P.☼’ button.
- ▶ Press the ‘>’ button.
- ▶ Press the ‘**Rinse the coffee system**’ button to start the rinse operation.

‘**Machine is rinsing**’, water flows out of the coffee spout. The operation stops automatically.

### Rinsing the fine foam frother

After each milk preparation, the E8 prompts you to perform a milk system rinse.

- i** In programming mode, you can set whether the milk system rinsing is to be prompted 10 minutes after preparation or initiated automatically (see Chapter 4 ‘Permanent settings in programming mode – Milk system rinsing’).
- i** This chapter applies to the **professional fine foam frother** and the **fine foam frother**.

**Precondition:** ‘**Rinse the milk system**’ is displayed.

- ▶ Place a receptacle under the fine foam frother.
- ▶ Press the ‘P.☼’ button.
- ▶ Press the ‘>’ button.
- ▶ Press the ‘**Rinse the milk system**’ button to start the rinse operation.

‘**Milk system is being rinsed**’ appears and the fine foam frother is rinsed. The operation stops automatically.



## Cleaning the fine foam frother

To ensure that the fine foam frother always works properly, you must clean it **daily** when you have been preparing milk.

### CAUTION

If the wrong cleaning agent is used, the machine could be damaged and/or traces could be left behind in the water.

- ▶ Use only original JURA maintenance products.

- i** JURA milk system cleaner is available from specialised dealers.
- i** To clean the milk system, use the container supplied.
- i** This chapter applies to the **professional fine foam frother** and the **fine foam frother**.

- ▶ Press the 'P:☼' button.
- ▶ Press the 'Clean the milk system' button.
- ▶ Press the 'Start' button.
- ▶ Press the 'Next' button.
- ▶ Remove the milk pipe from the milk container or carton.
- ▶ Add milk system cleaner to the front part of the container up to the **bottom mark** (indicated by ☼).
- ▶ Then fill with water up to the **upper mark**.
- ▶ Place the container under the fine foam frother.



- ▶ Connect the milk pipe to the container.
- i** To connect the milk pipe to the container correctly, the pipe must be fitted with a connector.
- ▶ Press the 'Next' button.
- ▶ 'Milk system is being cleaned' appears and the fine foam frother and the milk pipe are cleaned.
- ▶ Rinse the container thoroughly and fill the front part with 250 ml of fresh water.
- ▶ Place this under the fine foam frother and reconnect the milk pipe to the container.

- ▶ Press the 'Next' button.  
'Milk system is being cleaned' appears and the fine foam frother and the milk pipe are rinsed with fresh water.  
The start screen is displayed.

### Dismantling and rinsing the professional fine foam frother

To make sure the professional fine foam frother works properly, and in the interests of hygiene, it must be dismantled and rinsed **daily** if you have been preparing milk.

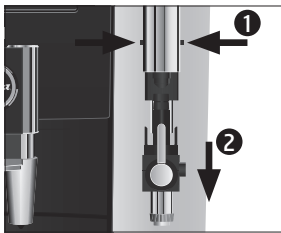

- ▶ Remove the milk pipe and rinse it thoroughly under running water.
- ▶ Remove the professional fine foam frother.

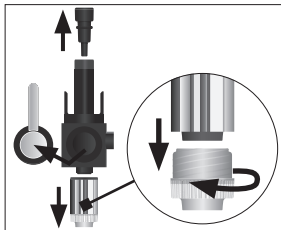

- ▶ Dismantle the professional fine foam frother into its individual parts.
- ▶ Rinse all the parts under running water. If there are severely dried-on milk residues, firstly immerse the individual parts in a solution of 250 ml cold water and 1 capful of JURA milk system cleaner. Then rinse the parts thoroughly.

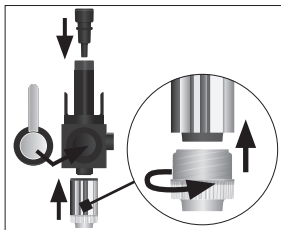

- ▶ Re-assemble the professional fine foam frother.

- i** Ensure that all individual parts are correctly and firmly connected to ensure optimum operation of the professional fine foam frother.

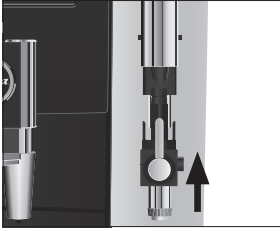

- ▶ Re-fit the professional fine foam frother on the milk system.

### Dismantling and rinsing the fine foam frother

To make sure the fine foam frother works properly, and in the interests of hygiene, it must be dismantled and rinsed **daily** if you have been preparing milk.

- ▶ Remove the milk pipe and rinse it thoroughly under running water.
- ▶ Remove the fine foam frother.

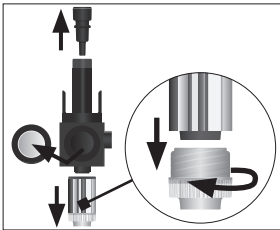
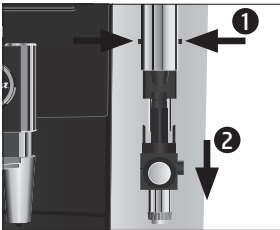

- ▶ Dismantle the fine foam frother into its individual parts.
- ▶ Rinse all the parts under running water. If there are severely dried-on milk residues, firstly immerse the individual parts in a solution of 250 ml cold water and 1 capful of JURA milk system cleaner. Then rinse the parts thoroughly.

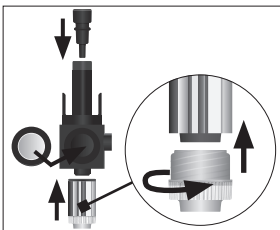

- ▶ Re-assemble the fine foam frother.
- i** Ensure that all individual parts are correctly and firmly connected to ensure optimum operation of the fine foam frother.

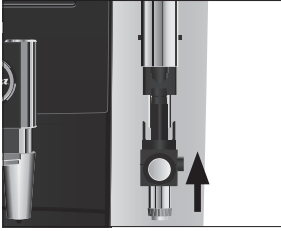

- ▶ Re-fit the fine foam frother on the milk system.

## Inserting/changing the filter

Your E8 no longer has to be descaled if you are using the CLARIS Smart filter cartridge.

- i** Once the filter cartridge stops working (depending on the water hardness setting), the E8 will prompt you to change the filter.
- i** CLARIS Smart filter cartridges are available from specialised dealers.

**Precondition:** The start screen is displayed.

- ▶ Remove and empty the water tank.
- ▶ Fit the filter cartridge extension supplied on top of a **new** CLARIS Smart filter cartridge.
- ▶ Insert the filter cartridge with its extension into the water tank.
- ▶ Turn the filter cartridge clockwise until it audibly clicks into place.
- ▶ Fill the water tank with fresh, cold water and reinsert the tank.

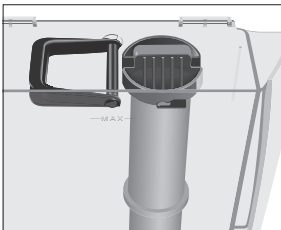

‘Saved’ appears briefly on the display. The machine has automatically detected that you have just inserted/changed the filter cartridge.

‘Filter is being rinsed’, the water flows directly into the drip tray.

Rinsing of the filter stops automatically. The start screen is displayed.

## Cleaning the machine

After 180 preparations or 80 switch-on rinses, the E8 will prompt you to clean it.

### CAUTION

If the wrong cleaning agent is used, the machine could be damaged and/or traces could be left behind in the water.

- ▶ Use only original JURA maintenance products.

- i** The cleaning programme lasts approximately 20 minutes.
- i** Do not interrupt the cleaning programme. The quality of cleaning will be impaired if you do so.
- i** JURA cleaning tablets are available from specialised dealers.

**Precondition:** 'Clean machine' is displayed.

- ▶ Press the 'P:☼' button.
  - ▶ Press the 'Start' button.
  - ▶ Press the 'Next' button.
- 'Empty coffee grounds container'
- ▶ Empty the drip tray and coffee grounds container and put them back into the machine.

'Clean'

- ▶ Place a receptacle under the coffee spout.
  - ▶ Press the 'Next' button.
- 'Machine is being cleaned', water flows out of the coffee spout.
- The operation is interrupted, 'Add cleaning tablet'.
- ▶ Open the cover of the filler funnel for ground coffee.

- ▶ Insert a JURA cleaning tablet into the filler funnel.
- ▶ Close the cover of the filler funnel.
- ▶ Press the 'Next' button.

'Machine is being cleaned', water flows out of the coffee spout several times.

The operation stops automatically.

'Empty coffee grounds container'

- ▶ Empty the drip tray and coffee grounds container and put them back into the machine.

Cleaning is now complete. The start screen is displayed.



## Descaling the machine

The E8 builds up deposits of limescale over time and automatically prompts you to descale it when necessary. The degree of calcification depends on the hardness of your water.

- i** If you are using a CLARIS Smart filter cartridge, you will not be prompted to descale.

---

**⚠ CAUTION** If the descaling agent comes into contact with the skin or eyes, this can cause irritation.

- ▶ Avoid contact with the skin or eyes.
- ▶ Rinse off the descaling agent with clean water. Should you get any descaling agent in your eye, see a doctor.

---

**CAUTION** If the wrong descaling agent is used, the machine could be damaged and/or traces could be left behind in the water.

- ▶ Use only original JURA maintenance products.

---

**CAUTION** If the descaling operation is interrupted, there may be damage to the machine.

- ▶ Allow the descaling programme to run to the end.

---

**CAUTION** If the descaling agent comes into contact with sensitive surfaces (e.g. marble), damage cannot be ruled out.

- ▶ Clean up any splashes immediately.

---

**i** The descaling programme lasts approximately 40 minutes.

**i** JURA descaling tablets are available from specialised dealers.

**Precondition:** 'Decalcify machine' is displayed.

- ▶ Press the 'P:⚙️' button.
- ▶ Press the 'Start' button.
- ▶ Press the 'Next' button.  
'Empty drip tray'
- ▶ Empty the drip tray and coffee grounds container and put them back into the machine.  
'Agent in tank'
- ▶ Remove and empty the water tank.



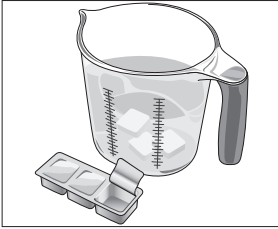

- ▶ Completely dissolve the contents of one blister (3 JURA descaling tablets) in a receptacle holding 500 ml of lukewarm water. This may take several minutes.
- ▶ Pour the solution into the empty water tank and insert it into the machine.



- ▶ Place a receptacle under the fine foam frother.
- ▶ Press the 'Next' button.  
'Machine is being descaled' appears and water flows out of the fine foam frother repeatedly.  
The operation is interrupted, 'Empty drip tray'.
- ▶ Empty the drip tray and coffee grounds container and put them back into the machine.  
'Fill water tank'



- ▶ Remove the water tank and rinse it thoroughly.
- ▶ Fill the water tank with fresh, cold water and reinsert the tank.
- ▶ Place one receptacle under the coffee spout and another under the fine foam frother.
- ▶ Press the 'Next' button.  
'Machine is being descaled', the descaling operation is continued.  
The operation is interrupted, 'Empty drip tray'.
- ▶ Empty the drip tray and coffee grounds container and put them back into the machine.  
Descaling is now complete. The start screen is displayed.

**i** If the descaling operation stops unexpectedly, rinse the water tank thoroughly.

## Cleaning the bean container

Coffee beans may be covered with a slight oil film which remains on the walls of the bean container. These traces may negatively affect the coffee result. For this reason clean the bean container from time to time.

**Precondition:** 'Fill bean container' is displayed.

- ▶ Switch the machine off with the On/Off button .
- ▶ Remove the aroma preservation cover.
- ▶ Clean the bean container with a soft, dry cloth.
- ▶ Fill the bean container with coffee beans and close the aroma preservation cover.

## Descaling the water tank

Limescale deposits may form in the water tank. To ensure correct function of the machine, descale the water tank from time to time.

- ▶ Remove the water tank.
- ▶ If you use a CLARIS Smart filter cartridge, remove this.
- ▶ Completely fill the water tank and dissolve 3 JURA descaling tablets in it.
- ▶ Leave the water tank with the descaling solution for several hours (e.g. overnight).
- ▶ Empty the water tank and rinse it thoroughly.
- ▶ If you use a CLARIS Smart filter cartridge, insert this again.
- ▶ Fill the water tank with fresh, cold water and reinsert the tank.