



GIGA W3 Professional

Maintenance instructions



These maintenance instructions do not replace the ‘GIGA W3 Professional Instructions for Use’. Make sure you read and observe the safety information and warnings first in order to avoid hazards.

| | |
|---|---|
| Clean the milk system..... | 2 |
| Dismantling and rinsing the dual spout..... | 3 |
| Changing the filter..... | 5 |
| Cleaning the machine..... | 7 |
| Descaling the machine | 9 |

Clean the milk system

Clean the milk system

Equipment required:
Milk system cleaner
250 ml (Art. 63801)



Precondition: »Please select product:«



»Maintenance status (1/5)«

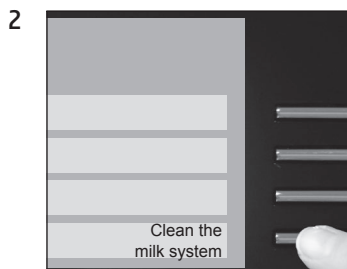

»Cleaning agent for milk system.«

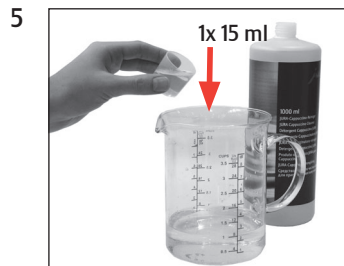
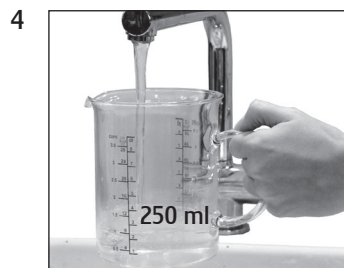

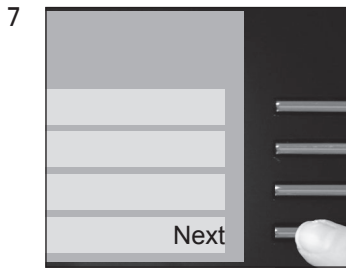

»Milk system is being rinsed.«
»Water for cleaning milk system.«

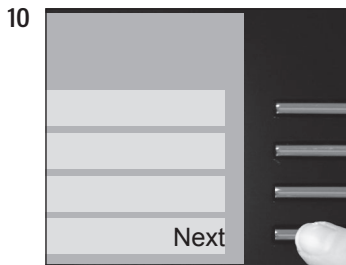
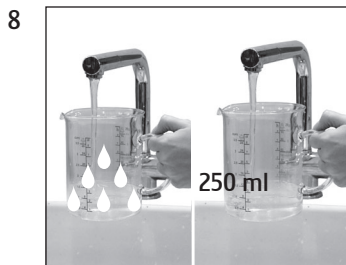

»Milk system is being rinsed.«
»Milk system cleaning complete.«
»Please select product:«

Dismantling and rinsing the dual spout

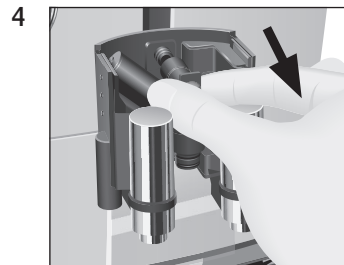
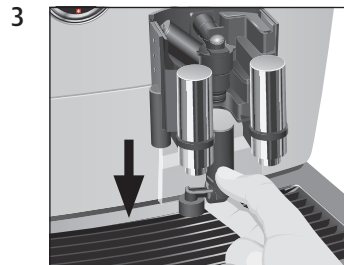
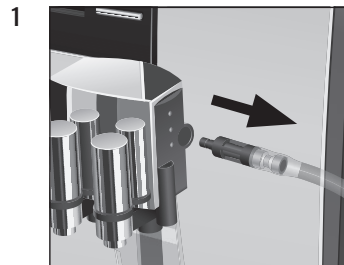

Dismantling and rinsing the dual spout

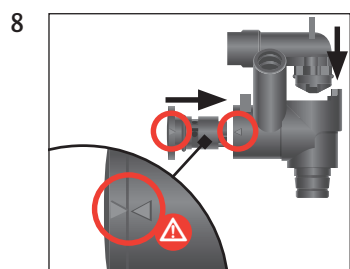
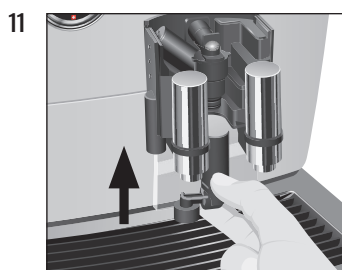
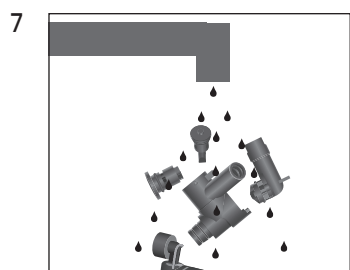
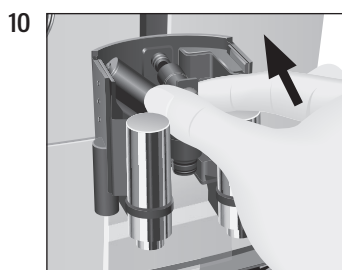
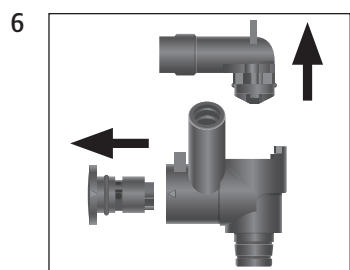
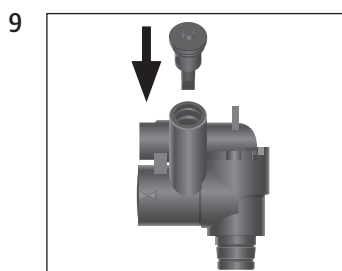
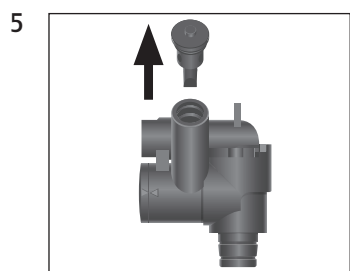

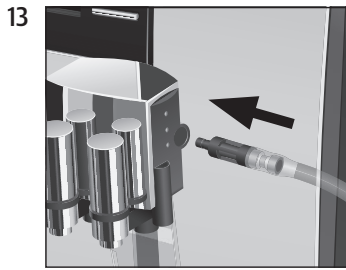

Changing the filter

Equipment required:
CLARIS Pro Blue filter cartridge
Pack of 4 (Art. 69670)



Precondition: »Change the filter«



»Maintenance status (1/5)«

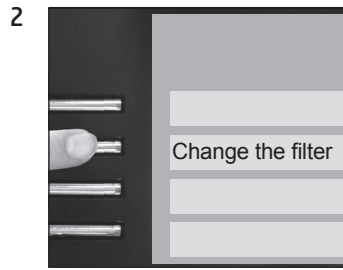

»Change filter.« /
»Press the Rotary Switch.«

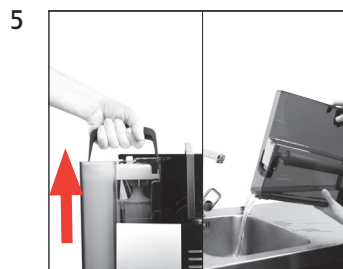

Changing the filter

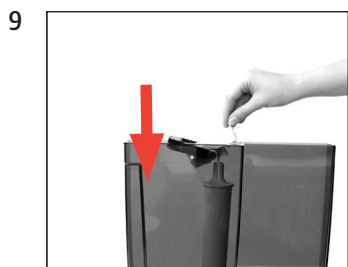
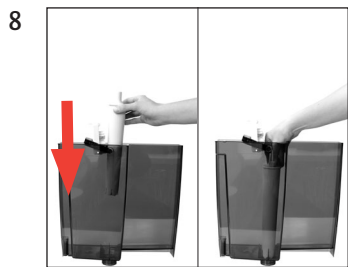
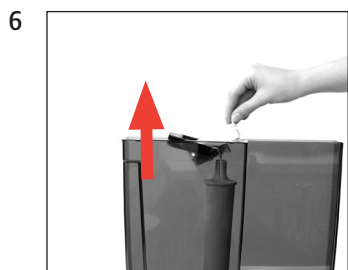

»Filter is being rinsed.«

»Empty drip tray.«



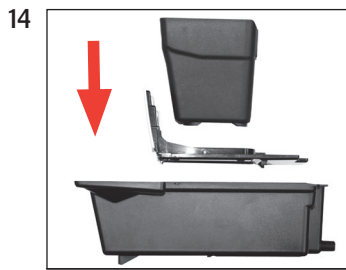

»Change the filter.« / »Filter rinsing complete.«

»Please select product:«

Cleaning the machine

Approximate duration 20 min.

Equipment required:
2-phase cleaning tablets
Pack of 6 (Art. 62715)



Precondition: »Clean machine.«
(or: »Please select product:«)



»Maintenance status (1/5)«

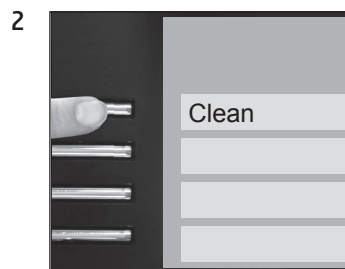

»Empty coffee grounds container.«



Cleaning the machine

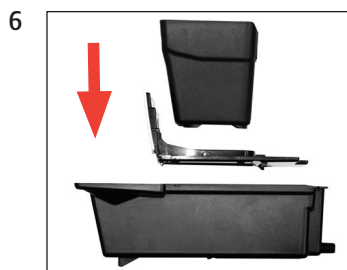
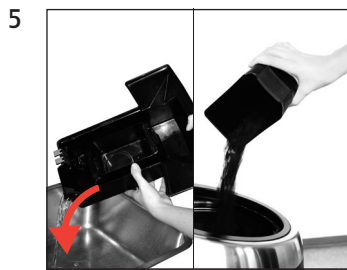

»Press the Rotary Switch.«



»Machine is being cleaned.«

»Add cleaning tablet.«

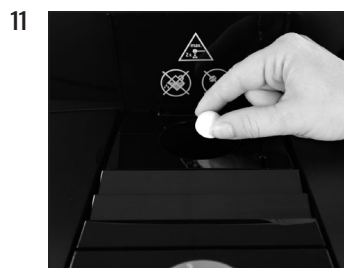

»Press the Rotary Switch.«



»Machine is being cleaned.«
»Empty coffee grounds container.«

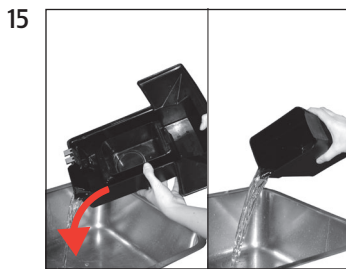
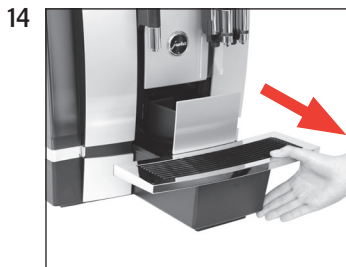

»Clean« / »Cleaning complete.«
»Please select product:«

Descaling the machine

Approximate duration 50 min.

Equipment required:

Descaling tablets
Pack of 3 (Art. 61848)



Precondition: »Decalcify machine.«
(or »Please select product:«)



»Maintenance status (1/5)«

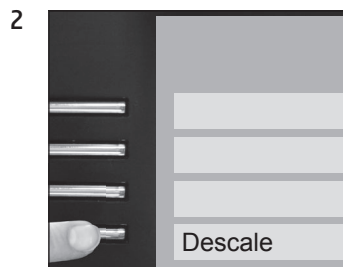

Descaling the machine

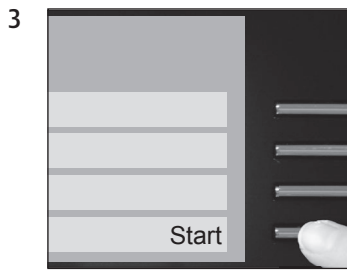

»Empty drip tray.«

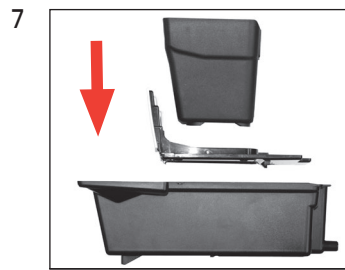
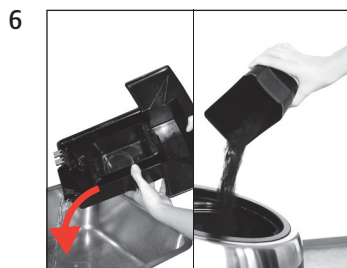

»Pour descaling agent into water tank.«

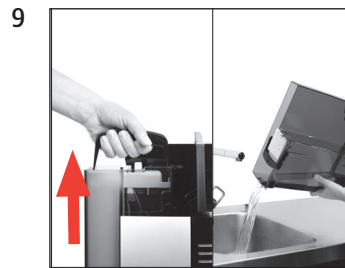

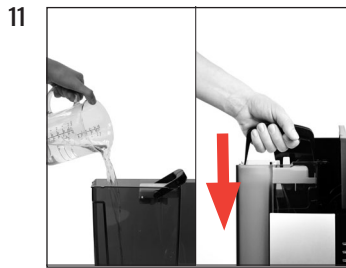

»Press the Rotary Switch.«



»Machine is being descaled.«

»Empty drip tray.«

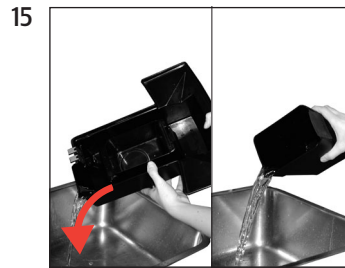

»Fill water tank.«

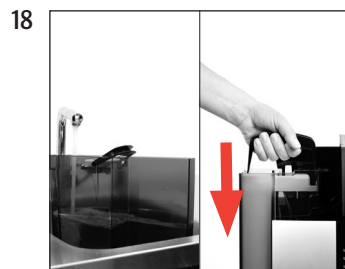
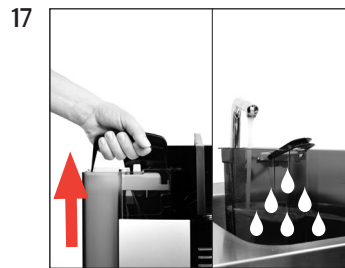

»Press the Rotary Switch.«

Descaling the machine



»Descale« / »Descaling complete.«

»Please select product:«

»Machine is being descaled.«

»Empty drip tray.«

