

GIGA X3 Professional



Cleaning the machine

Approximate duration 20 min.

Equipment required:
 2-phase cleaning tablets
 Tub of 25 (Art. 62535)
 Pack of 6 (Art. 62715)



These short instructions do not replace the 'GIGA X3 Professional Instructions for Use'. Make sure you read and observe the safety information and warnings first in order to avoid hazards.

Precondition: »Clean machine.«
 (or: »Please select product:«)



»Maintenance status (1/5)«

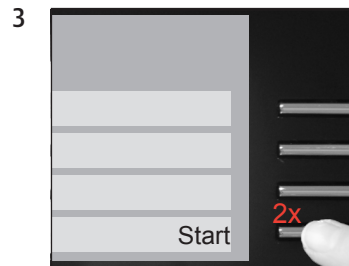
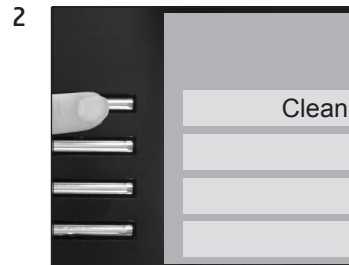

»Empty coffee grounds container.«

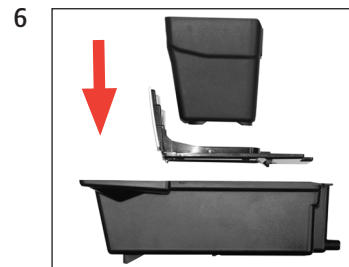
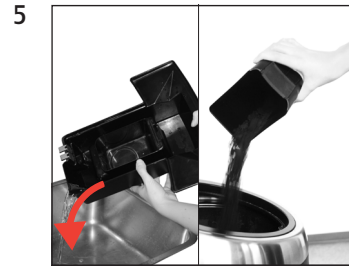

»Press the Rotary Switch.«



»Machine is being cleaned.«
 »Add cleaning tablet.«

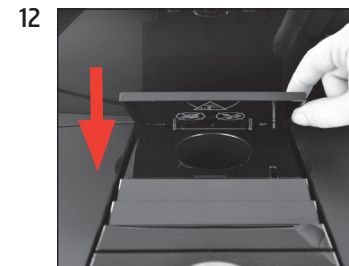
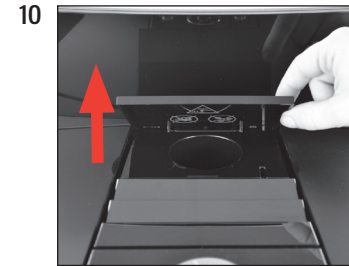

»Press the Rotary Switch.«



»Machine is being cleaned.«
 »Empty coffee grounds container.«

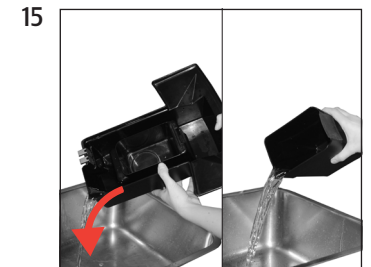

»Clean« / »Cleaning complete.«
 »Please select product:«