

jura®



IMPRESSA C60/C65 Instructions for Use



For your safety: read and understand manual before use.

Your IMPRESSA C60/C65

IMPORTANT SAFEGUARDS	4
Control elements	8
1 Preparing and using for the first time	10
JURA on the Internet.....	10
Setting up the machine	10
Filling the bean container.....	10
First-time use	11
Determining the water hardness	13
Adjusting the grinder	14
Filling the water tank.....	14
Connecting milk.....	15
2 Preparation	16
Espresso and coffee	17
Two specialty coffees at the touch of a button.....	17
Cappuccino.....	18
Milk foam.....	19
Ground coffee.....	19
Permanently setting the amount of water for the cup size	20
Hot water	21
3 Daily operation	22
Switching on	22
Daily maintenance	22
Switching off.....	23
4 Permanent settings in programming mode	24
Product settings	25
Setting the water hardness	26
Energy-saving mode	27
Automatic switch-off.....	28
Unit for amount of water.....	28
Language.....	29
5 Maintenance	30
Rinsing the machine.....	31
Rinsing the fine foam frother.....	31
Cleaning the fine foam frother	32
Dismantling and rinsing the fine foam frother.....	33
Dismantling and rinsing the professional fine foam frother.....	34
Inserting and activating the filter.....	34
Changing the filter	36
Cleaning the machine	37
Descaling the machine	39
Cleaning the bean container.....	41
Descaling the water tank.....	41

6	Display messages	42
7	Troubleshooting	43
8	Transport and environmentally friendly disposal	44
	Transport / Emptying the system.....	44
	Disposal.....	44
9	Technical data	45
10	Index	46
11	JURA contact details / Legal information	48

Symbol description

Warnings



This is the safety alert symbol. It is used to alert you to potential personal injury hazards. Obey all safety messages that follow this symbol to avoid possible injury or death.



DANGER indicates a hazardous situation which, if not avoided, will result in death or serious injury.



WARNING indicates a hazardous situation which, if not avoided, could result in death or serious injury.



CAUTION, used with the safety alert symbol, indicates a hazardous situation which, if not avoided, could result in minor or moderate injury.



NOTICE is used to address practices not related to personal injury.

Symbols used



Prompt to take action. This symbol means that you are being prompted to perform some action.



Information and tips to make it even easier to use your IMPRESSA.

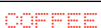

Display message

IMPORTANT SAFEGUARDS

Follow the basic safety precautions

When using electrical appliances, basic safety precautions shall always be followed, to reduce the risk of fire, electric shock, and/or injury to persons, including the following:

- Read all instructions.
- Do not touch hot surfaces. Use handles or knobs.
- To protect against fire, electric shock and injury to persons, do not immerse power cord, plugs, or body of machine in water or other liquid.
- Close supervision is necessary when any appliance is used by or near children.
- Unplug from outlet when not in use and before cleaning. Allow to cool before putting on or taking off parts, and before cleaning the appliance.
- Do not operate any appliance with a damaged cord or plug or after the appliance malfunctions, or has been damaged in any manner. Return appliance to the nearest authorized service facility for examination, repair or adjustment.
- The use of an accessory attachment not recommended by the appliance manufacturer may result in fire, electric shock, or injury to persons.
- Do not use outdoors.
- Do not let the cord hang over the edge of a table or counter, or touch hot surfaces.
- Do not place on or near a hot gas or electric burner, or in a heated oven.
- To disconnect, turn any control to 'OFF' then remove plug from wall outlet.
- Do not use appliance for other than intended use.
- Use extreme caution when dispensing hot steam, hot water or hot coffee.
- For household use only.

SAVE THESE INSTRUCTIONS.

Pass them on to any subsequent user.

Intended use The appliance is designed and intended for household use only. It shall only be used for coffee preparation and to heat milk and water, according to these instructions. Use for any other purpose will be deemed improper. JURA Elektroapparate AG cannot accept any responsibility for the consequences of improper use.

People, including children, who

- do not have the physical, sensory or mental capabilities to use the appliance safely or
- are inexperienced or lack knowledge in how to use the appliance safely

must be supervised by a responsible person when using it, or must be instructed in how to use it correctly.

Special power cord set instructions

- A short power-supply cord is to be provided to reduce risks resulting from becoming entangled in or tripping over a longer cord.
- The cord shall be arranged so that it will not drape over the counter top or table top where it can be pulled on by children or tripped over.
- This appliance has a 3-pin grounded plug.
- Do not modify the plug in any way.

Extension cords are available and may be used if care is exercised in their use.

If the user chooses to use an extension cord,

- the marked electrical rating of the extension cord should be at least as great as the electrical rating of the appliance, and
- if the appliance is of the grounded type, the extension cord should be a grounding type 3-wire cord, and
- the longer cord should be arranged so that it will not drape over the counter top or tabletop where it can be pulled on by children or tripped over.

⚠ WARNING



To reduce the risk of fire or electric shock, DO NOT remove any service covers. DO NOT modify the appliance in any way that is not described in these instructions. NO user serviceable parts included. Repair MUST be done by authorized personnel only.

In the event of signs of damage, for example if there is a smell of burning, unplug the machine immediately from outlet and contact JURA customer service.

IMPORTANT SAFEGUARDS

⚠ CAUTION

This appliance is for household use. Any servicing other than cleaning and user maintenance shall be performed by an authorized service representative:

- Do not immerse base in water or try to disassemble.
- Do not put the appliance or any individual parts in the dishwasher.
- Check voltage to be sure that the voltage indicated on the name plate complies with your voltage.
- Never use warm or hot water to fill the water container. Use cold water only.
- Keep your hands and the cord away from hot parts of the appliance during operation.

There is a risk of scalds or burns on the spouts and the cappuccino frother / nozzle.

- Keep children away.
- Do not touch any hot parts. Use the handles or knobs provided.
- Ensure that the cappuccino frother / nozzle is correctly fitted and clean. If incorrectly fitted or if they become blocked, the cappuccino frother or its parts might come off.

NOTICE

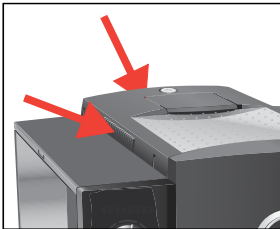

- Never clean with scouring powders or hard implements.
- Ensure that the ventilation slots are not covered.
- Never pull out the drip tray during the brewing process. Only pull the drip tray when the display instructs you or when the appliance is ready for use.

**NEVER DO
(or you will void your
warranty protection):**

- Never fill instant coffee, chocolate mix etc. into the bean container or ground coffee funnel (filler funnel for ground coffee). It will damage the functioning of the brewing chamber.
- Never fill sugar coated coffee beans into the bean container. In case of doubt, call your dealer.
- Never fill anything other than coffee beans into the bean container (no chocolate, no rice, no nuts, no spices, nothing other than roasted coffee beans).
- Never fill frozen beans into the bean container. If you store beans in the freezer, let them thaw 3 to 4 hours before filling them into the bean container.
- Never fill anything but fresh, cold and clean water into the water tank, except when decalcifying.
- Never use mineral or carbonated water. You can use tap water, bottled water, spring water and reverse osmosis water.
- Never do anything with the machine which is not described in these instructions. In case of doubt, call your dealer.

Control elements

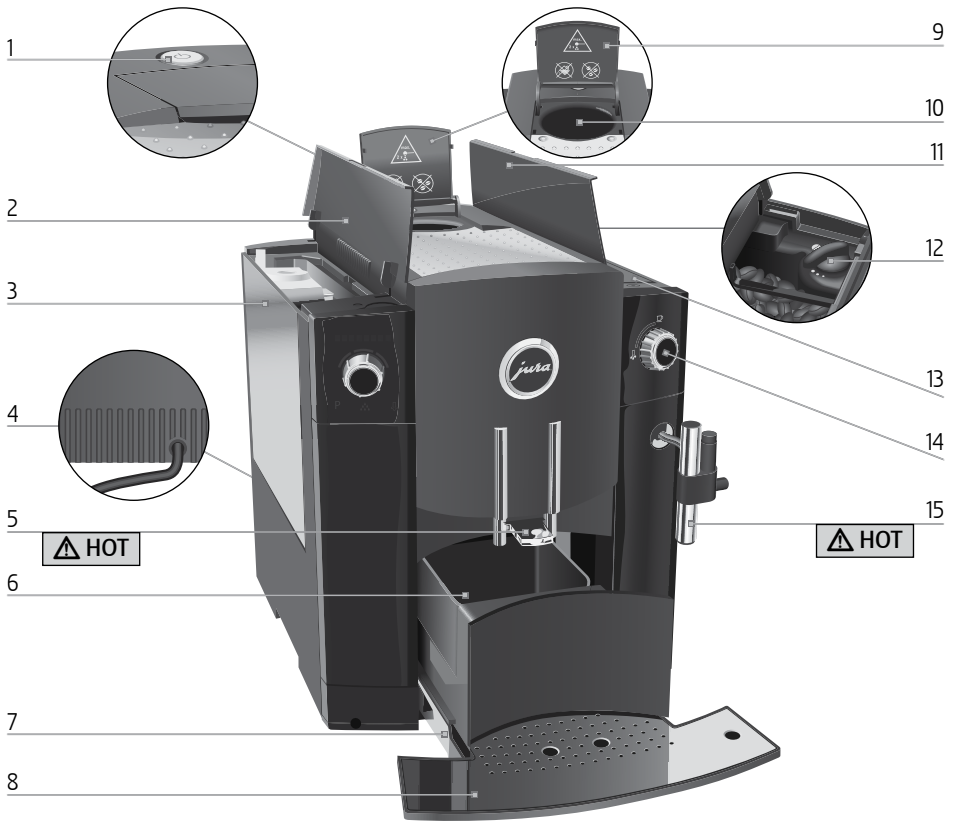

Figure: Your machine may look different to the one shown.

- | | | | |
|---|----------------------------------|----|--|
| 1 | ⏻ On/Off button | 9 | Filler funnel cover |
| 2 | Water tank cover | 10 | Filler funnel for ground coffee |
| 3 | Water tank | 11 | Bean container cover |
| 4 | Power cord (back of the machine) | 12 | Grinder adjustment switch |
| 5 | Height-adjustable coffee spout | 13 | Bean container with aroma preservation cover |
| 6 | Coffee grounds container | 14 | Switch for hot water and steam preparation |
| 7 | Drip tray | 15 | Fine foam frother |
| 8 | Cup platform | | |



- 1 Display
- 2 Rotary Switch

- 3 P P symbol (programming)
- 4 ☸ Maintenance symbol
- 5 ⚙ Steam symbol

The Connector System® permits the use of different cappuccino frothers. These are available from specialized dealers.

Professional fine foam frother (optional)

Milk foam
Hot milk



Fine foam frother (standard)

Milk foam

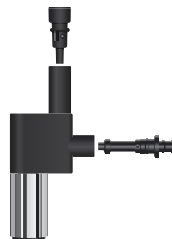

1 Preparing and using for the first time

JURA on the Internet

Visit us on the Internet (www.jura.com). You will find interesting and up-to-date information on your IMPRESSA and on every aspect of coffee.

Setting up the machine

When setting up your IMPRESSA, please note the following:

- Place the IMPRESSA on a horizontal surface that is not sensitive to water.
- Choose a spot for your IMPRESSA which protects the machine against overheating. Ensure that the ventilation slots are not covered.

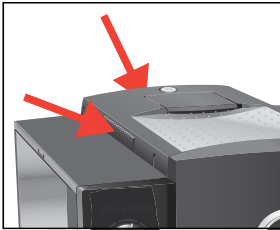

Filling the bean container

The bean container has an aroma preservation cover. This will ensure that your coffee beans retain their aroma for longer.

NOTICE

Coffee beans which have been treated with additives (e.g. sugar), ground coffee or freeze-dried coffee will damage the grinder.

- ▶ Only use roasted, untreated coffee beans to fill the bean container.
-
- ▶ Open the bean container cover and remove the aroma preservation cover.
 - ▶ Remove any dirt or foreign objects from inside the bean container.
 - ▶ Fill the bean container with coffee beans, then close the aroma preservation cover and the bean container cover.

First-time use

When using the machine for the first time, you can choose whether you want to operate IMPRESSA **with** or **without** the CLEARLYL Blue filter cartridge. If the water hardness is 10 °dH or more, we recommend using the filter cartridge. If you do not know the hardness of your water, you can find this out first (see Chapter 1 'Preparing and using for the first time – Determining the water hardness').



WARNING

If the machine is operated with a defective power cord, there is a danger of potentially fatal electric shock.



- ▶ Never use a machine which is damaged.
- ▶ Never use a machine which has a defective power cord.

- i** The water volume is given as standard in 'oz'. You can change this setting to 'ml' in programming mode (see Chapter 4 'Permanent settings in programming mode – Unit for amount of water').

Precondition: The bean container has been filled.

- ▶ Insert the power plug into a power socket.
-  ▶ Press the On/Off button to switch the IMPRESSA on.
LANGUAGE EN appears on the display.
-  ▶ Press the Rotary Switch to confirm the language.
OK appears briefly on the display to confirm the setting.
FILTER ✓ / YES
- i** Now decide whether you want to operate your IMPRESSA **with** or **without** a CLEARLYL Blue filter cartridge.

First-time use with filter cartridge activation

-  ▶ Press the Rotary Switch.
OK appears briefly on the display.
FILTER INSERT, the Maintenance symbol  lights up.
-  ▶ Touch the Maintenance symbol.
FILL TANK
- ▶ Open the water tank cover.
- ▶ Remove the water tank and rinse it with cold water.
- ▶ Open the filter holder.
- ▶ Remove the CLEARLYL Blue filter cartridge from the Welcome Pack.

1 Preparing and using for the first time



- ▶ Insert the CLEARYL Blue filter cartridge into the water tank, exerting slight pressure.
- ▶ Close the filter holder. It will click into place audibly.

i After three months, the filter will cease to work. Set the date on the date plate on the filter holder in the water tank.

- ▶ Fill the water tank with fresh, cold water and reinsert the tank.

SWITCH OPEN, the light segment on the switch lights up.

- ▶ Place one receptacle under the coffee spout and another under the fine foam frother.

 ▶ Turn the switch to the  position.

FILTER RINSING, water flows out of the fine foam frother.

i You can interrupt rinsing of the filter at any time. To do this, turn the switch clockwise. Turn the switch anticlockwise to continue rinsing the filter.

i The water may be slightly discolored. This is not harmful to health and does not affect the taste.

Rinsing of the filter stops automatically after approximately 17 oz (500 ml). **SWITCH CLOSE** appears on the display.

 ▶ Turn the switch to the  position.

SYSTEM FILLING, the system fills up with water.

HEATING, the machine heats up.

RINSING, the system is rinsed. Water flows out of the coffee spout. The rinse stops automatically. **ESPRESSO** appears on the display. Your IMPRESSA is ready for use.

First-time use without filter cartridge activation

 ▶ Turn the Rotary Switch until **FILTER -- / NO** is displayed.



 ▶ Press the Rotary Switch.

OK appears briefly on the display.

16 ° FH

i If you do not know the hardness of your water, you must find this out first (see Chapter 1 'Preparing and using for the first time – Determining the water hardness').

 ▶ Turn the Rotary Switch to change the water hardness setting, e.g. to **25 ° FH**.

- ▶ Press the Rotary Switch.
OK appears briefly on the display.
FILL TANK
 - ▶ Open the water tank cover.
 - ▶ Remove the water tank and rinse it with cold water.
 - ▶ Fill the water tank with fresh, cold water and reinsert the tank.
SWITCH OPEN, the light segment on the switch lights up.
 - ▶ Place one receptacle under the coffee spout and another under the fine foam frother.
- ▶ Turn the switch to the  position.
SYSTEM FILLING, the system fills up with water.
SWITCH CLOSE
 - ▶ Turn the switch to the  position.
SYSTEM FILLING, the system fills up with water.
HEATING, the machine heats up.
RINSING, the system is rinsed. Water flows out of the coffee spout. The rinse stops automatically. **ESPRESSO** appears on the display. Your IMPRESSA is ready for use.

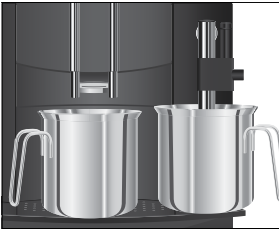

Determining the water hardness

You can find out what the water hardness is by using the Aquadur® test strip supplied as standard.

- ▶ Hold the test strip briefly (for 1 second) under flowing water. Shake off the water.
- ▶ Wait for about 1 minute.
- ▶ You will then be able to read the degree of water hardness from the discoloration of the Aquadur® test strip and the description on the packaging.

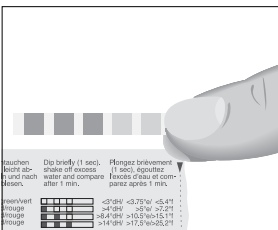

Level	Display German Degree (°dH)	Degrees of general hardness (°dGH)	Parts per million (ppm)	Indicator Strip number of 'reddish' fields
Not active	–	–	–	–
Very soft water	<3	<3	< 53.4	None
Soft water	> 4	> 4	> 71	1
Hard water	> 8.4	> 8.4	> 150	2
Very hard water	> 14	> 14	> 250	3

Adjusting the grinder

You can adjust the grinder on a continuous scale to suit the degree of roast of your coffee.

NOTICE If you adjust the consistency of grind when the grinder is not operating, the grinder adjustment switch could be damaged.

- ▶ Only adjust the consistency of grind when the grinder is running.

The consistency of grind is correct if the coffee flows regularly from the coffee spout. In addition a fine, thick crema forms.

Example: Proceed as follows to change the consistency of grind **during** the preparation of an espresso.

- ▶ Place a cup under the coffee spout.
- ▶ Open the bean container cover and remove the aroma preservation cover.
- ▶  Press the Rotary Switch to start preparation.
- ▶ Turn the grinder adjustment switch to the desired position **while** the grinder is running.

The preset amount of water flows into the cup. Preparation stops automatically.

- ▶ Fit the aroma preservation cover.
- ▶ Close the bean container cover.

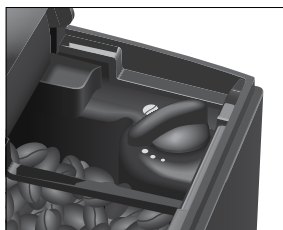

Filling the water tank

Daily maintenance of the machine and hygiene when handling milk, coffee and water are key to a perfect coffee result in the cup every time. You should therefore change the water **daily**.

NOTICE Milk, sparkling mineral water or other liquids can damage the water tank or the machine.

- ▶ Only fill the water tank with fresh, cold water.

- ▶ Open the water tank cover.
- ▶ Remove the water tank and rinse it with cold water.
- ▶ Fill the water tank with fresh, cold water and reinsert the tank.
- ▶ Close the water tank cover.



Connecting milk

Your IMPRESSA creates fine, creamy, feather-light milk foam with a perfect consistency. The most important requirement for frothing milk is a milk temperature of 39–46 °F (4–8 °C). We would therefore recommend using a milk cooler or a vacuum milk container.

- ▶ Remove the protective cover from the fine foam frother.
- ▶ Connect the milk pipe to the fine foam frother. To do this, attach the end of the milk pipe to the connector on the right-hand side of the fine foam frother. Use the short pipe for a milk container and the long pipe for a milk carton.
- ▶ Connect the other end of the milk pipe to a milk container or immerse it in a milk carton (Figure: optional JURA stainless steel vacuum milk container).

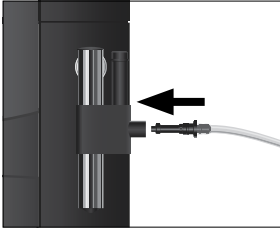

2 Preparation

⚠ WARNING

Hot coffee, hot steam and hot water can cause scalding. Scalding is a serious burn.

- ▶ Use extreme care when handling hot liquid or steam.
 - ▶ Allow liquid to cool down before drinking.
 - ▶ In the event of scalding, rinse affected area with cold water and seek medical attention.
 - ▶ Keep children AWAY.
-

i You can stop the machine at any time while a specialty coffee, steam or hot water is being prepared. Just press the Rotary Switch (for a specialty coffee) or return the switch to its original position (for steam and hot water).

i During the grinding operation you can select the coffee strength of **single products** by turning the Rotary Switch : **MILD, NORMAL, STRONG** or **EXTRA**.

i During preparation, you can change the preset **amount of water** for a specialty coffee by turning the Rotary Switch .

i You can follow the current status of preparation on the progress bar.

i The last specialty coffee prepared is always displayed, even if the IMPRESSA was switched off in the meantime.

i The water volume is given as standard in ‘oz’. You can change this setting to ‘ml’ in programming mode (see Chapter 4 ‘Permanent settings in programming mode – Unit for amount of water’).

Coffee tastes best served hot. A cold porcelain cup cools the beverage – and impairs the taste. We therefore recommend prewarming the cups. The full coffee aroma can develop only in prewarmed cups. You can purchase a JURA cup warmer from your specialized dealer.

You can make **permanent settings** for all products in programming mode (see Chapter 4 ‘Permanent settings in programming mode – Product settings’).

Espresso and coffee

Espresso and coffee are both prepared following this model.

Example: Proceed as follows to prepare one coffee.

Precondition: ESPRESSO is displayed (example).

- ▶ Place a cup under the coffee spout.
- ▶ Turn the Rotary Switch until COFFEE is displayed.
- ▶ Press the Rotary Switch.

Preparation starts. COFFEE and the coffee strength are displayed. The preset amount of water for coffee flows into the cup.

Preparation stops automatically. COFFEE appears on the display.



Two specialty coffees at the touch of a button

When you prepare two drinks at once, the amount of water selected for the single product is used for each cup.

The preparation of two espressos and two coffees follows this same model.

Example: Proceed as follows to prepare two espressi.

Precondition: ESPRESSO is displayed (example).

- ▶ Place two espresso cups under the coffee spout.
- ▶ Press the Rotary Switch twice (**within 2 seconds**), to start preparation of two espressi.

2 CUPS

Preparation starts. The preset amount of water flows into the cups.

Preparation stops automatically. ESPRESSO appears on the display (example).



Cappuccino

For a cappuccino you must first froth the milk using the fine foam frother. You then prepare an espresso straight into the milk foam.

- i** This chapter applies to the **professional fine foam frother** and the **fine foam frother**.

Precondition: **ESPRESSO** is displayed (example). Milk is connected to the fine foam frother.



- ▶ Place a cup under the fine foam frother.

- i** If you are using the **professional fine foam frother**, turn the selector switch to the Milk Foam position .



-  ▶ Touch the Steam symbol.

HEATING / STEAM

As soon as the machine has heated up, **STEAM / READY** appears, the light segment on the switch lights up.

-  ▶ Turn the switch to the  position.

STEAM appears and the milk foam is prepared.

-  ▶ When the cup is about two thirds full of milk foam, turn the switch to the  position.

STEAM / READY

- i** You can continue to prepare steam for the next 40 seconds or so without the machine having to heat up again.

- i** Touch the Steam symbol . **ESPRESSO** appears on the display (example). Now you can prepare specialty coffees again.

- ▶ Place the cup under the coffee spout.

-  ▶ Press the Rotary Switch.

Coffee preparation starts. The preset amount of water for espresso flows into the cup.

Preparation stops automatically. **ESPRESSO** appears on the display.

To ensure that the fine foam frother always works properly, you must clean it **daily** when you have been preparing milk (see Chapter 5 ‘Maintenance – Cleaning the fine foam frother’). Your IMPRESSA will **not** prompt you to clean the fine foam frother.





Milk foam



- i** This chapter applies to the **professional fine foam frother** and the **fine foam frother**.
- i** With the professional fine foam frother, available as an optional accessory, you can also prepare hot milk.

Example: Proceed as follows to prepare milk foam.

Precondition: **ESPRESSO** is displayed (example). Milk is connected to the fine foam frother.

- ▶ Place a cup under the fine foam frother.
- i** If you are using the **professional fine foam frother**, turn the selector switch to the Milk Foam position .
- ⬇ ▶ Touch the Steam symbol.
HEATING / STEAM
As soon as the machine has heated up, **STEAM / READY** appears, the light segment on the switch lights up.
-  ▶ Turn the switch to the  position.
STEAM appears and the milk foam is prepared.
-  ▶ When there is enough milk foam in the cup, turn the switch back to the  position.
STEAM / READY
- i** You can continue to prepare steam for the next 40 seconds or so without the machine having to heat up again.

To ensure that the fine foam frother always works properly, you must clean it **daily** when you have been preparing milk (see Chapter 5 'Maintenance – Cleaning the fine foam frother'). Your IMPRESSA will **not** prompt you to clean the fine foam frother.

Ground coffee

You can choose to use a second coffee variety, for example decaffeinated coffee, with the filter funnel for ground coffee.



- i** Never add more than two level measuring spoons of ground coffee.
- i** Use ground coffee which is not ground too finely. Very fine coffee can block up the system so that the coffee only comes out in drips.
- i** If you did not fill the machine with a sufficient amount of ground coffee, **LOW FILL GROUND C** is displayed and the IMPRESSA stops the operation.

- i** The desired specialty coffee must be prepared within approximately one minute after filling with the ground coffee. Otherwise the IMPRESSA stops the operation and is once more ready for use.

All specialty coffees with ground coffee are prepared following this model.

Example: Proceed as follows to prepare a coffee using ground coffee.



Precondition: ESPRESSO is displayed (example).

- ▶ Place a cup under the coffee spout.
-  ▶ Turn the Rotary Switch until GROUND C is displayed.
-  ▶ Press the Rotary Switch.

FILL GROUND C

- ▶ Open the cover of the filler funnel for ground coffee.
- ▶ Place one level measuring spoon of ground coffee into the filler funnel.
- ▶ Close the cover of the filler funnel.
-  ▶ Press the Rotary Switch.

ESPRESSO (example)

-  ▶ Turn the Rotary Switch until COFFEE is displayed.
-  ▶ Press the Rotary Switch.

Preparation starts. COFFEE, the preset amount of water for coffee flows into the cup.

Preparation stops automatically. COFFEE appears on the display.

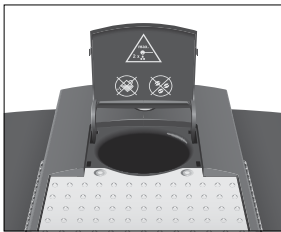

Permanently setting the amount of water for the cup size

It is easy to make permanent settings for the amount of water for all specialty coffees according to the cup size. Adjust the amount once as shown in the following example. Every time you prepare a drink in the future, this amount of water will be dispensed.

The process for permanently adapting the amount of water to the cup size is the same for all specialty coffees.

Example: Proceed as follows to **permanently** set the amount of water for one coffee.

Precondition: ESPRESSO is displayed (example).



- ▶ Place a cup under the coffee spout.
- ▶ Turn the Rotary Switch until **COFFEE** is displayed.
- ▶ Press and **hold** the Rotary Switch.
COFFEE
- ▶ Continue to **hold** the Rotary Switch until **ENOUGH COFFEE ?** appears.
- ▶ Release the Rotary Switch.
Preparation starts and the coffee flows into the cup.
- ▶ As soon as there is sufficient coffee in the cup, press the Rotary Switch.
Preparation stops. **OK** appears briefly on the display. The set amount of water for one coffee is permanently stored. **COFFEE** appears on the display.

i You can alter this setting at any time by repeating the above procedure.

i You can also permanently set the amount of water for all specialty coffees in programming mode (see Chapter 4 'Permanent settings in programming mode – Product settings').

Hot water

- ⚠ CAUTION** There is a danger of scalding from hot water splashes.
- ▶ Avoid direct contact with the skin.

Example: Proceed as follows to prepare hot water.

Precondition: **ESPRESSO** is displayed (example).

- ▶ Place a cup under the fine foam frother.
- ▶ Turn the switch to the **☺** position.
WATER, water flows out of the fine foam frother.
- ▶ When there is enough water in the cup, turn the switch back to the **☹** position.
ESPRESSO appears on the display (example).



3 Daily operation

Switching on



Daily maintenance of the machine and hygiene when handling milk, coffee and water are key to a perfect coffee result in the cup every time. You should therefore change the water **daily**.

- ▶ Place a receptacle under the coffee spout.
- ▶ Press the On/Off button to switch the IMPRESSA on.

HEATING

RINSING, the system is rinsed. The rinse stops automatically. ESPRESSO appears on the display (example). Your IMPRESSA is ready for use.

Daily maintenance



To ensure that you get many years of reliable service out of your IMPRESSA and to guarantee the optimum coffee quality, the machine requires daily maintenance.

- ▶ Pull out the drip tray.
- ▶ Empty the coffee grounds container and the drip tray. Rinse them both with warm water.
- ▶ Refit the coffee grounds container and the drip tray.
- ▶ Rinse the water tank with clean water.
- ▶ Clean the fine foam frother (see Chapter 5 'Maintenance – Cleaning the fine foam frother').
- ▶ Dismantle and rinse the fine foam frother (see Chapter 5 'Maintenance – Dismantling and rinsing the fine foam frother').
- ▶ Wipe the surface of the machine with a clean, soft, damp cloth (e.g. microfiber cloth).

i In the interests of hygiene, we recommend changing the milk pipe on a regular basis (approx. every 3 months). Replacement pipes are available from specialized dealers.

Switching off



When the IMPRESSA is switched off, the system is automatically rinsed if a specialty coffee has been prepared.

Precondition: ESPRESSO is displayed (example).

- ▶ Place a receptacle under the coffee spout.
 - ▶ Press the On/Off button.
- RINSING, the system is rinsed. The operation stops automatically. Your IMPRESSA is switched off.

i When the IMPRESSA is switched off with the On/Off button, the machine consumes less than 0.01 W of standby energy.

4 Permanent settings in programming mode

⚠ WARNING

Hot coffee, hot steam and hot water can cause scalding. Scalding is a serious burn.

- ▶ Use extreme care when handling hot liquid or steam.
- ▶ Allow liquid to cool down before drinking.
- ▶ In the event of scalding, rinse affected area with cold water and seek medical attention.
- ▶ Keep children AWAY.

You can make permanent settings in programming mode. You can navigate through the program items and permanently save the required settings simply by turning and pressing the Rotary Switch. You can make the following settings with the Rotary Switch:

Program item	Sub-item	Explanation
RINSE	RINSE, CLEAN, FILTER (only if filter is activated), DESCALE (only if filter is not activated)	▶ Select the desired maintenance program.
BUTTONS		▶ Select your settings for specialty coffees.
FILTER ✓ / FILTER -	YES, NO	▶ Indicate whether you are operating your IMPRESSA with or without a CLEARYL Blue filter cartridge.
HARDNESS (only if filter is not activated)	1 °dH - 30 °dH	▶ Adjust the water hardness.
ENERGY ✓ / ENERGY -	SAVE ✓, SAVE -	▶ Choose whether you want to operate your IMPRESSA with or without energy-saving mode.
OFF FROM	15 MIN., 30 MIN., 1 HRS. - 15 HRS.	▶ Set the time after which the IMPRESSA should switch off automatically.
DISPLAY	ML, OZ	▶ Select the unit for the amount of water.
LANGUAGE		▶ Select your language.
EXIT		▶ Exit programming mode.

i You can exit programming mode directly at any time. Simply touch the P symbol for approximately 2 seconds.

Product settings

WARNING

Hot coffee, hot steam and hot water can cause scalding. Scalding is a serious burn.

- ▶ Use extreme care when handling hot liquid or steam.
- ▶ Allow liquid to cool down before drinking.
- ▶ In the event of scalding, rinse affected area with cold water and seek medical attention.
- ▶ Keep children AWAY.







In the program item **BUTTONS** you can make individual settings for espresso and coffee. The following permanent settings can be made:

Product	Amount	Coffee strength	Temperature
Espresso, coffee	Volume: 0.5 OZ – 8.0 OZ (25 ml – 240 ml)	MILD, NORMAL, STRONG, EXTRA	NORMAL, HIGH
2 cups	When you prepare two drinks at once, the temperature and amount of water selected for the single product are used for each cup.		



Permanent settings in programming mode always follow the same model.

Example: Proceed as follows to change the coffee strength for one coffee from **NORMAL** to **STRONG**.

Precondition: **ESPRESSO** is displayed (example).

- P** ▶ Touch the P symbol for **approximately 2 seconds** until **RINSE** appears on the display.
-  ▶ Turn the Rotary Switch until **BUTTONS** is displayed.
-  ▶ Press the Rotary Switch to enter the program item.
ESPRESSO
-  ▶ Turn the Rotary Switch until **COFFEE** is displayed.
-  ▶ Press the Rotary Switch.
VOLUME
-  ▶ Turn the Rotary Switch until **STRENGTH** is displayed.
-  ▶ Press the Rotary Switch to enter the program item.
NORMAL
-  ▶ Turn the Rotary Switch until **STRONG** is displayed.

4 Permanent settings in programming mode

-  ▶ Press the Rotary Switch to confirm the setting.
OK appears briefly on the display.
STRENGTH
-  ▶ Turn the Rotary Switch until **EXIT** is displayed.
-  ▶ Press the Rotary Switch to exit the program item.
ESPRESSO
- P** ▶ Touch the P symbol to exit programming mode.
ESPRESSO (example)

Setting the water hardness





The harder the water is, the more frequently the IMPRESSA needs to be descaled. It is therefore important to set the water hardness accurately.

The water hardness can be adjusted on a continuous scale between 1 °dH and 30 °dH.

-  If you are using the CLEARYL Blue filter cartridge and have activated it, it is not possible to set the water hardness.

Example: Proceed as follows to change the water hardness setting from **16 °dH** to **25 °dH**.

Precondition: **ESPRESSO** is displayed (example).

- P** ▶ Touch the P symbol for **approximately 2 seconds** until **RINSE** appears on the display.
-  ▶ Turn the Rotary Switch until **HARDNESS** is displayed.
-  ▶ Press the Rotary Switch to enter the program item.
16 °dH
-  ▶ Turn the Rotary Switch until **25 °dH** is displayed.
-  ▶ Press the Rotary Switch to confirm the setting.
OK appears briefly on the display.
HARDNESS
- P** ▶ Touch the P symbol to exit programming mode.
ESPRESSO (example)





Energy-saving mode

The energy-saving mode (Energy Save Mode, E.S.M.®) helps you to prevent your machine from consuming power unnecessarily and to actively save energy:

- ENERGY ✓
 - Soon after the last preparation, the IMPRESSA stops heating up. After about 5 minutes the message ENERGY ✓ is displayed.
 - Before you can prepare a specialty coffee, steam or hot water, the machine must heat up.
- ENERGY —
 - All specialty coffees as well as hot water can be prepared without having to wait.
 - Before you can prepare steam, the machine must heat up.

Example: Proceed as follows to change the energy-saving mode from ENERGY ✓ to ENERGY —.

Precondition: ESPRESSO is displayed (example).

- P** ▶ Touch the P symbol for **approximately 2 seconds** until RINSE appears on the display.
-  ▶ Turn the Rotary Switch until ENERGY ✓ is displayed.
-  ▶ Press the Rotary Switch to enter the program item.
SAVE ✓
-  ▶ Turn the Rotary Switch until SAVE — is displayed.
-  ▶ Press the Rotary Switch to confirm the setting.
OK appears briefly on the display.
ENERGY —
- P** ▶ Touch the P symbol to exit programming mode.
ESPRESSO (example)





Automatic switch-off

By instructing your IMPRESSA to automatically switch itself off, you can cut down your energy consumption. If this function is activated, your IMPRESSA switches off automatically after the preset time following the last action on the machine.

You can set the automatic switch-off to 15 minutes, 30 minutes or 1–15 hours.

Example: Proceed as follows to change the switch-off time from **2 HRS.** to **1 HRS.**.

Precondition: **ESPRESSO** is displayed (example).





- P** ▶ Touch the P symbol for **approximately 2 seconds** until **RINSE** appears on the display.
-  ▶ Turn the Rotary Switch until **OFF FROM** is displayed.
-  ▶ Press the Rotary Switch to enter the program item.
2 HRS.
-  ▶ Turn the Rotary Switch until **1 HRS.** is displayed.
-  ▶ Press the Rotary Switch to confirm the setting.
OK appears briefly on the display.
OFF FROM
- P** ▶ Touch the P symbol to exit programming mode.
ESPRESSO (example)

Unit for amount of water

In the program item **DISPLAY** you can select the unit used for the amount of water.

Example: Proceed as follows to change the unit for the amount of water from **ML** to **OZ**.

Precondition: **ESPRESSO** is displayed (example).





- P** ▶ Touch the P symbol for **approximately 2 seconds** until **RINSE** appears on the display.
-  ▶ Turn the Rotary Switch until **DISPLAY** is displayed.
-  ▶ Press the Rotary Switch to enter the program item.
ML
-  ▶ Turn the Rotary Switch until **OZ** is displayed.
-  ▶ Press the Rotary Switch to confirm the setting.
OK appears briefly on the display.
DISPLAY
- P** ▶ Touch the P symbol to exit programming mode.
ESPRESSO (example)

Language

In the program item **LANGUAGE** you can select the language used by your IMPRESSA.

Example: Proceed as follows to change the language from **EN** to **DE**.

Precondition: **ESPRESSO** is displayed (example).

- P** ▶ Touch the P symbol for **approximately 2 seconds** until **RINSE** appears on the display.
-  ▶ Turn the Rotary Switch until **LANGUAGE** is displayed.
-  ▶ Press the Rotary Switch to enter the program item.
EN
-  ▶ Turn the Rotary Switch until **DE** is displayed.
-  ▶ Press the Rotary Switch to confirm the setting.
OK appears briefly on the display.
SPRACHE
- P** ▶ Touch the P symbol to exit programming mode.
ESPRESSO (example)

5 Maintenance

⚠ WARNING

Use of maintenance products that are harmful to health and discharge of liquids during maintenance program. Harmful if swallowed. Irritating to eyes and skin.

- ▶ Keep children AWAY.
 - ▶ Keep children away from the machine while it is performing a maintenance program.
 - ▶ Avoid contact with skin and eyes.
 - ▶ Avoid generation of dust. Do not inhale dust.
 - ▶ When using do not eat or drink.
 - ▶ Keep maintenance products away from food, drink and animal food.
 - ▶ Keep container tightly closed and dry. Keep in a cool place.
-

Your IMPRESSA has the following integrated maintenance programs:

- Rinsing the machine (RINSE)
 - Cleaning the machine (CLEAN)
 - Changing the filter (FILTER) (only if filter is activated)
 - Descaling the machine (DESCALE) (only if filter is not activated)
- i** Clean the machine, change the filter or descale the machine when you are prompted to do so.
- i** You can start the maintenance programs at any time in programming mode (program item RINSE).
- i** Your IMPRESSA will not prompt you to clean the fine foam frother. In the interests of hygiene, you should clean the fine foam frother **daily** when you have been preparing milk.

Rinsing the machine



You can initiate the rinse operation manually at any time.

Precondition: **ESPRESSO** is displayed (example).

- ▶ Place a receptacle under the coffee spout.
 - P** ▶ Touch the **P** symbol for **approximately 2 seconds** until **RINSE** appears on the display.
 - ⏻ ▶ Press the Rotary Switch to enter the program item. **RINSE**
 - ⏻ ▶ Press the Rotary Switch to initiate the rinse operation. **RINSING**, water flows out of the coffee spout.
- The rinse stops automatically. **ESPRESSO** appears on the display (example).

Rinsing the fine foam frother

- i** This chapter applies to the **professional fine foam frother** and the **fine foam frother**.

To ensure that the fine foam frother always works properly, you must rinse it with water **after every** milk preparation.

Your IMPRESSA will **not** prompt you to rinse the fine foam frother.

Precondition: **ESPRESSO** is displayed (example).

- ▶ Remove the milk pipe from the milk container or carton.
 - ▶ Fill a receptacle with 8.5 oz (250 ml) of fresh water.
 - ▶ Immerse the milk pipe in the receptacle.
 - ▶ Place a receptacle under the fine foam frother.
 - ⏻ ▶ Touch the Steam symbol. **HEATING / STEAM**
- As soon as the machine has heated up, **STEAM / READY** appears, the light segment on the switch lights up.
- ⌚ ▶ Turn the switch to the ⏻ position. **STEAM** appears and the fine foam frother and the milk pipe are rinsed with fresh water.
 - ⌚ ▶ When clean water starts to flow out of the frother, turn the switch back to the ⏻ position. **STEAM / READY**



The rinsing of the fine foam frother is now complete.

Cleaning the fine foam frother

i This chapter applies to the **professional fine foam frother** and the **fine foam frother**.

To ensure that the fine foam frother always works properly, you must clean it **daily** when you have been preparing milk. Your IMPRESSA will **not** prompt you to clean the fine foam frother.

⚠ WARNING

Non-recommended cleaning agents will not optimally remove milk residues. This may cause the cappuccino frother to become blocked and fly off the machine. Discharge of hot steam.

- ▶ Use only original JURA milk system cleaner.

⚠ WARNING

Harmful and irritating cleaning agent. Harmful if swallowed. Irritating to eyes and skin.

- ▶ Keep children AWAY.
- ▶ Avoid contact with skin and eyes.
- ▶ After contact with skin, wash immediately with plenty of water. In case of skin irritation, seek medical advice.
- ▶ After eye contact, immediately flush eyes with plenty of water and seek medical advice.
- ▶ If swallowed, rinse mouth immediately and drink large quantities of water. Do not induce vomiting. Seek medical advice immediately and show label.

i JURA milk system cleaner is available from specialized dealers.

Precondition: ESPRESSO is displayed (example).

- ▶ Remove the milk pipe from the milk container or carton.
- ▶ Pour 8.5 oz (250 ml) of fresh water into a receptacle and add one capful of JURA milk system cleaner.
- ▶ Immerse the milk pipe in the receptacle.
- ▶ Place a receptacle under the fine foam frother.
- ⚡ ▶ Touch the Steam symbol.

HEATING / STEAM

As soon as the machine has heated up, STEAM / READY appears, the light segment on the switch lights up.



- ▶ Turn the switch to the ⚡ position.

STEAM appears and the fine foam frother and the milk pipe are cleaned.



- ▶ As soon as the receptacle containing the cleaning solution is empty, turn the switch to the ☐ position.
 STEAM / READY
- ▶ Rinse the receptacle thoroughly, fill it with 8.5 oz (250 ml) of fresh water and immerse the milk pipe in the water.
- ▶ Empty the other receptacle and place it under the fine foam frother once more.
- ▶ Turn the switch to the ☒ position.
 STEAM, the fine foam frother and the milk pipe are rinsed with fresh water.
- ▶ As soon as the receptacle containing the fresh water is empty, turn the switch to the ☐ position.
 STEAM / READY
 The cleaning of the fine foam frother is now complete.

Dismantling and rinsing the fine foam frother

To make sure the fine foam frother works properly, and in the interests of hygiene, it must be dismantled and rinsed **daily** if you have been preparing milk. Your IMPRESSA will not prompt you to dismantle and rinse the frother.

- ▶ Remove the milk pipe and rinse it thoroughly under running water.
- ▶ Carefully remove the fine foam frother from the Connector System® by twisting slightly.
- ▶ Dismantle the fine foam frother into its individual parts.
- ▶ Rinse all the parts of the fine foam frother thoroughly under running water. If there are severely dried-on milk residues, firstly immerse the individual parts in a solution of 8.5 oz (250 ml) cold water and one capful of JURA milk system cleaner. Then rinse the parts thoroughly.
- ▶ Re-assemble the fine foam frother.

- i** Ensure that all individual parts are correctly and firmly connected to ensure optimum operation.
- ▶ Firmly attach the fine foam frother to the Connector System®.

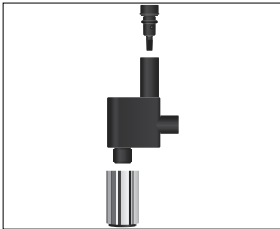

Dismantling and rinsing the professional fine foam frother

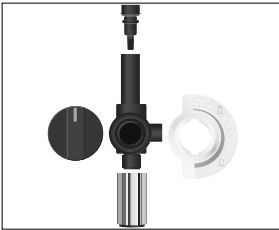

To make sure the professional fine foam frother works properly, and in the interests of hygiene, it must be dismantled and rinsed **daily** if you have been preparing milk. Your IMPRESSA will not prompt you to dismantle and rinse the frother.

- ▶ Remove the milk pipe and rinse it thoroughly under running water.
 - ▶ Carefully remove the professional fine foam frother from the Connector System® by twisting slightly.
 - ▶ Dismantle the professional fine foam frother into its individual parts.
 - ▶ Rinse all the parts of the professional fine foam frother thoroughly under running water. If there are severely dried-on milk residues, firstly immerse the individual parts in a solution of 8.5 oz (250 ml) cold water and one capful of JURA milk system cleaner. Then rinse the parts thoroughly.
 - ▶ Re-assemble the professional fine foam frother.
- i** Ensure that all individual parts are correctly and firmly connected to ensure optimum operation.
- ▶ Firmly attach the professional fine foam frother to the Connector System®.

Inserting and activating the filter

Your IMPRESSA no longer has to be descaled if you are using the CLEARYL Blue filter cartridge. If you did not activate the filter cartridge the first time you used the machine, you can do this now as follows.

- i** Perform the ‘inserting the filter’ operation without any interruptions. This will ensure that your IMPRESSA always produces its best.

Precondition: **ESPRESSO** is displayed (example).

- P**
- ▶ Touch the P symbol for **approximately 2 seconds** until **RINSE** appears on the display.
 - ▶ Turn the Rotary Switch until **FILTER --** is displayed.
 - ▶ Press the Rotary Switch to enter the program item.
NO
 - ▶ Turn the Rotary Switch until **YES** is displayed.



- ▶ Press the Rotary Switch to confirm the setting.
OK appears briefly on the display.
FILTER INSERT, the Maintenance symbol  lights up.
- ▶ Remove and empty the water tank.
- ▶ Open the filter holder.
- ▶ Remove the CLEARYL Blue filter cartridge from the Welcome Pack.
- ▶ Insert the CLEARYL Blue filter cartridge into the water tank, exerting slight pressure.
- ▶ Close the filter holder. It will click into place audibly.



- i** After three months, the filter will cease to work. Set the date on the date plate on the filter holder in the water tank.

- ▶ Fill the water tank with fresh, cold water and reinsert the tank.
- ▶ Place a receptacle (at least 17 oz or 500 ml) under the fine foam frother.





-  ▶ Touch the Maintenance symbol.
SWITCH OPEN, the light segment on the switch lights up.
-  ▶ Turn the switch to the  position.
FILTER RINSING, water flows out of the fine foam frother.

- i** You can interrupt rinsing of the filter at any time. To do this, turn the switch clockwise. Turn the switch anticlockwise to continue rinsing the filter.

- i** The water may be slightly discolored. This is not harmful to health and does not affect the taste.

Rinsing of the filter stops automatically after approximately 17 oz (500 ml). SWITCH CLOSE appears on the display.

-  ▶ Turn the switch to the  position.
HEATING, the machine heats up.
ESPRESSO appears on the display (example). The filter is now activated.

Changing the filter

- i** After 2000 oz (60 liters) of water have flowed through, the filter will cease to work. Your IMPRESSA will automatically prompt you to change the filter.
- i** After three months, the filter will cease to work. Set the date on the date plate on the filter holder in the water tank.
- i** If the CLEARYL Blue filter cartridge is not activated in programming mode, you will not be prompted to change the filter.
- i** CLEARYL filter cartridges are available from specialized dealers.

Precondition: **FILTER / ESPRESSO** is displayed (example).

- ❖ ▶ Touch the Maintenance symbol for **approximately 2 seconds**.

FILTER CHANGE appears on the display.

- ▶ Remove and empty the water tank.
- ▶ Open the filter holder and remove the old CLEARYL Blue filter cartridge.
- ▶ Insert a **new** CLEARYL filter cartridge Blue into the water tank, exerting slight pressure.
- ▶ Close the filter holder. It will click into place audibly.
- ▶ Fill the water tank with fresh, cold water and reinsert the tank.



- ▶ Place a receptacle (at least 17 oz or 500 ml) under the fine foam frother.

- ❖ ▶ Touch the Maintenance symbol.

SWITCH OPEN, the light segment on the switch lights up.

- ⦿ ▶ Turn the switch to the **↓** position.

FILTER RINSING, water flows out of the fine foam frother.

- i** You can interrupt rinsing of the filter at any time. To do this, turn the switch clockwise. Turn the switch anticlockwise to continue rinsing the filter.
- i** The water may be slightly discolored. This is not harmful to health and does not affect the taste.

Rinsing of the filter stops automatically after approximately 17 oz (500 ml). **SWITCH CLOSE** appears on the display.



- ▶ Turn the switch to the ☐ position.
HEATING, the machine heats up.
ESPRESSO appears on the display (example).

Cleaning the machine

After 200 preparations or 80 switch-on rinses, the IMPRESSA will prompt you to clean it.

WARNING



Non-recommended (e.g. liquid) cleaning agents may contain substances that could damage the machine or leave residues.

- ▶ Use only original JURA cleaning tablets. These are specially formulated for your machine.

WARNING

Harmful and irritating cleaning agent. Harmful if swallowed. Irritating to eyes and skin.

- ▶ Keep children AWAY.
- ▶ Avoid contact with skin and eyes.
- ▶ Avoid generation of dust. Do not inhale dust.
- ▶ After contact with skin, wash immediately with plenty of water. In case of skin irritation, seek medical advice.
- ▶ After eye contact, immediately flush eyes with plenty of water and seek medical advice.
- ▶ If swallowed, rinse mouth immediately and drink large quantities of water. Do not induce vomiting. Seek medical advice immediately and show label.

-  The cleaning program lasts approximately 20 minutes.
-  Do not interrupt the cleaning program. The quality of cleaning will be impaired if you do so.
-  JURA cleaning tablets are available from specialized dealers.

Precondition: CLEAN / ESPRESSO is displayed (example).

- ❖ ▶ Touch the Maintenance symbol for **approximately 2 seconds**.
EMPTY TRAY appears on the display.
- ▶ Empty the drip tray and coffee grounds container and put them back into the machine.
PRESS RINSE

5 Maintenance

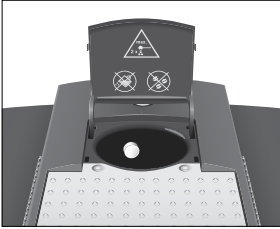

- ▶ Place a receptacle under the coffee spout.
- ⚠ ▶ Touch the Maintenance symbol.
CLEANING, water flows out of the coffee spout.
The operation is interrupted, **ADD TABLET**.
- ▶ Open the cover of the filler funnel for ground coffee.
- ▶ Insert a JURA cleaning tablet into the filler funnel.
- ▶ Close the cover of the filler funnel.
- ⚠ ▶ Touch the Maintenance symbol.
CLEANING, water flows out of the coffee spout several times.
The operation stops automatically.
EMPTY TRAY
- ▶ Empty the drip tray and coffee grounds container and put them back into the machine.
HEATING
ESPRESSO appears on the display (example). Cleaning is now complete. Your IMPRESSA is once more ready for use.

Descaling the machine

The IMPRESSA builds up deposits of limescale over time and automatically prompts you to descale it when necessary. The degree of calcification depends on the hardness of your water.

WARNING

Non-recommended descaling agents (e.g. vinegar) may contain substances that could damage the machine or leave residues.

- ▶ Use only original JURA descaling tablets. These are specially formulated for your machine.

WARNING

Harmful and irritating descaling agent. Harmful if swallowed.





Irritating to eyes and skin.

- ▶ Keep children AWAY.
- ▶ Avoid contact with skin and eyes.
- ▶ Avoid generation of dust. Do not inhale dust.
- ▶ After contact with skin, wash immediately with plenty of water. In case of skin irritation, seek medical advice.
- ▶ After eye contact, immediately flush eyes with plenty of water. Remove contact lenses. Seek medical advice.
- ▶ If swallowed, rinse mouth immediately and drink large quantities of water. Do not induce vomiting. Seek medical advice immediately and show label.

NOTICE

If the descaling operation is interrupted, there may be damage to the machine.

- ▶ Allow the descaling program to run to the end.





-  The descaling program lasts approximately 45 minutes.
-  JURA descaling tablets are available from specialized dealers.
-  If you use a CLEARYL Blue filter cartridge and this is activated, you will not be prompted to descale.
-  If the descaling agent comes into contact with sensitive surfaces (e.g. marble), damage cannot be ruled out. Clean up any splashes immediately.

Precondition: **DESCALE / ESPRESSO** is displayed (example).

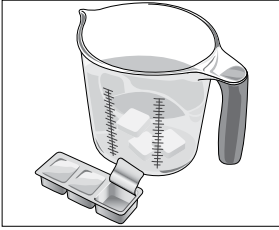
-  ▶ Touch the Maintenance symbol for **approximately 2 seconds**.
EMPTY TRAY appears on the display.
- ▶ Empty the drip tray and coffee grounds container and put them back into the machine.
AGENT IN TANK

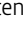
5 Maintenance



- ▶ Remove and empty the water tank.
- ▶ Completely dissolve the contents of one blister (3 JURA descaling tablets) in a receptacle holding 17 oz (500 ml) of water. This may take several minutes.
- ▶ Pour the solution into the empty water tank and insert it into the machine.
SWITCH OPEN, the light segment on the switch lights up.
- ▶ Carefully remove the fine foam frother from the Connector System[®] by twisting slightly.
- ▶ Place a receptacle (at least 17 oz or 500 ml) under the Connector System[®].
- ◉ ▶ Turn the switch to the  position.
DESCALE, water flows out of the Connector System[®] several times. The Maintenance symbol  flashes during the descaling operation.
The operation is interrupted, **SWITCH CLOSE**.
- ◉ ▶ Turn the switch to the  position.
DESCALE, the descaling operation is continued.
The operation is interrupted, **EMPTY TRAY**.
- ▶ Empty the drip tray and coffee grounds container and put them back into the machine.
FILL TANK
- ▶ Empty the receptacle and place it back under the Connector System[®].
- ▶ Place another receptacle under the coffee spout.
- ▶ Remove the water tank and rinse it thoroughly.
- ▶ Fill the water tank with fresh, cold water and reinsert the tank.
SWITCH OPEN, the light segment on the switch lights up.
- ◉ ▶ Turn the switch to the  position.
DESCALE, the descaling operation is continued.
The operation is interrupted, **SWITCH CLOSE**.
- ◉ ▶ Turn the switch to the  position.
DESCALE, the descaling operation is continued.
The operation is interrupted, **DESCALE**.
Water flows out of the coffee spout.
EMPTY TRAY
- ▶ Re-assemble the fine foam frother.

- ▶ Empty the drip tray and coffee grounds container and put them back into the machine.

ESPRESSO appears on the display (example). Descaling is now complete. Your IMPRESSA is once more ready for use.

- i** If the descaling operation stops unexpectedly, rinse the water tank thoroughly.

Cleaning the bean container

Coffee beans may be covered with a slight oil film which remains on the walls of the bean container. These traces may negatively affect the coffee result. For this reason clean the bean container from time to time.

Precondition: FILL BEANS is displayed.

- ⏻ ▶ Switch the machine off with the On/Off button.
- ▶ Open the bean container cover and remove the aroma preservation cover.
- ▶ Clean the bean container with a soft, dry cloth.
- ▶ Fill the bean container with coffee beans and close the aroma preservation cover.
- ▶ Close the bean container cover.

Descaling the water tank

Limescale deposits may form in the water tank. To ensure correct function of the machine, descale the water tank from time to time.

- ▶ Remove the water tank.
- ▶ If you use a CLEARYL Blue filter cartridge, remove this.
- ▶ Descale the tank with a mild conventional descaling agent in accordance with the manufacturer's instructions.
- ▶ Rinse out the water tank thoroughly.
- ▶ If you use a CLEARYL Blue filter cartridge, insert this again.
- ▶ Fill the water tank with fresh, cold water and reinsert the tank.

6 Display messages

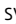
Message	Cause/Result	Action
FILL TANK	The water tank is empty. You cannot prepare any products.	▶ Fill the water tank (see Chapter 1 'Preparing and using for the first time – Filling the water tank').
EMPTY GROUNDS	The coffee grounds container is full. No specialty coffees can be prepared, but hot water preparation is possible.	▶ Empty the coffee grounds container and the drip tray (see Chapter 3 'Daily operation – Daily maintenance').
TRAY MISSING	The drip tray is not inserted correctly or is not inserted at all. You cannot prepare any products.	▶ Fit the drip tray.
FILL BEANS	The bean container is empty. No specialty coffees can be prepared, but hot water preparation is possible.	▶ Fill the bean container (see Chapter 1 'Preparing and using for the first time – Filling the bean container'). ▶ Press the Rotary Switch  to confirm that the bean container has been filled.
PRESS RINSE	The IMPRESSA is prompting you to continue a previously started maintenance program.	▶ Touch the Maintenance symbol  to continue the program.
FILTER / ESPRESSO (example)	The filter cartridge no longer works.	▶ Replace the CLEARYL Blue filter cartridge (see Chapter 5 'Maintenance – Changing the filter').
CLEAN / ESPRESSO (example)	The IMPRESSA is prompting you to clean it.	▶ Perform cleaning (see Chapter 5 'Maintenance – Cleaning the machine').
DESCALE / ESPRESSO (example)	The IMPRESSA is prompting you to descale it.	▶ Perform descaling (see Chapter 5 'Maintenance – Descaling the machine').
LOW FILL GROUND C	There is insufficient ground coffee in the machine; the IMPRESSA stops the operation.	▶ The next time you prepare a beverage, add more ground coffee (see Chapter 2 'Preparation – Ground coffee').
TOO HOT	The system is too hot to start a maintenance program.	▶ Wait for several minutes until the system has cooled or prepare a specialty coffee or hot water.

7 Troubleshooting

Problem	Cause/Result	Action
Insufficient foam is produced when the milk is frothed or milk sprays out of the fine foam frother.	The fine foam frother is dirty.	<ul style="list-style-type: none"> ▶ Clean the fine foam frother (see Chapter 5 'Maintenance – Cleaning the fine foam frother'). ▶ Dismantle and rinse the fine foam frother (see Chapter 5 'Maintenance – Dismantling and rinsing the fine foam frother').
Coffee only comes out in drips when it is being prepared.	Coffee or ground coffee has been ground too finely and is blocking the system. The same filter cartridge may have been used several times or the water hardness set incorrectly in the programming mode.	<ul style="list-style-type: none"> ▶ Put the grinder on a coarser setting or use coarser ground coffee (see Chapter 1 'Preparing and using for the first time – Adjusting the grinder'). ▶ Perform descaling (see Chapter 5 'Maintenance – Descaling the machine').
Water hardness cannot be adjusted.	The CLEARYL Blue filter cartridge is activated.	▶ Deactivate the filter cartridge in programming mode.
FILL TANK is displayed although the water tank is full.	The water tank float is trapped.	▶ Descale the water tank (see Chapter 5 'Maintenance – Descaling the water tank').
Grinder is making a very loud noise.	There are foreign objects in the grinder.	▶ Contact customer support in your country (see Chapter 11 'JURA contact details / Legal information').
ERROR 2 or ERROR 5 is displayed.	If the machine has been exposed to the cold for a long period of time, heating may be disabled for safety reasons.	▶ Warm the machine at room temperature.
Other ERROR messages are displayed.	–	Switch the machine off with the On/Off button. Contact customer support in your country (see Chapter 11 'JURA contact details / Legal information').

i If you were unable to solve the problem, contact customer support in your country (see Chapter 11 'JURA contact details / Legal information').

8 Transport and environmentally friendly disposal

Transport / Emptying the system

Keep the packaging for your IMPRESSA. It should be used to protect the machine during transport.

In order to protect the IMPRESSA from frost during transport, the system must be emptied.

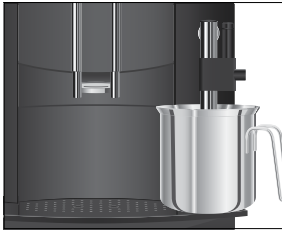

Precondition: ESPRESSO is displayed (example).

- ▶ Remove the milk pipe from the fine foam frother.
- ▶ Place a receptacle under the fine foam frother.

⬇ ▶ Touch the Steam symbol.

HEATING / STEAM

As soon as the machine has heated up, STEAM / READY appears, the light segment on the switch lights up.

⊙ ▶ Turn the switch to the ⬇ position.

STEAM appears and hot steam is discharged from the fine foam frother.

- ▶ Remove and empty the water tank.

Steam will continue to be discharged from the fine foam frother until the system is empty.

SWITCH CLOSE

⊙ ▶ Turn the switch to the ☞ position.

FILL TANK

⏻ ▶ Press the On/Off button.

Your IMPRESSA is switched off.

Disposal

Please dispose of old machines in an environmentally neutral way.



9 Technical data

Voltage	120 V ~, 60 Hz
Power	1450 W
Conformity mark	
Energy consumption	Approx. 9 Wh ENERGY ✓
Energy consumption	Approx. 15 Wh ENERGY -
Pump pressure	Static, max. 15 bar
Holding capacity of water tank	64 oz (1.9 l)
Holding capacity of bean container	7 oz (200 g)
Holding capacity of coffee grounds container	Max. 16 portions
Cord length	Approx. 47 in. (Approx. 1.2 m)
Weight	Approx. 21.2 lb (Approx. 9.6 kg)
Dimensions (W × H × D)	11 × 13.6 × 16.1 in. (28 × 34.5 × 41 cm)

Directives The machine complies with the following directives:

- Standard UL 1082
- Canadian Standard CSA C22.2 No. 64

10 Index

A

- Addresses 48
- Aroma preservation cover
 - Bean container with aroma preservation cover 8
- Automatic switch-off 28

B

- Bean container
 - Bean container with aroma preservation cover 8
 - Cleaning 41
 - Filling 10
- Bus bar
 - Technical data 45
- Button
 - On/Off button 8

C

- Cappuccino 18
- Cappuccino frother rinsing 31
- Cleaning
 - Bean container 41
 - Fine foam frother 32
 - Machine 37
- CLEARYL Blue filter cartridge
 - Changing 36
 - Inserting and activating the filter 34
- Coffee 17
- Coffee grounds container 8
- Coffee spout
 - Height-adjustable coffee spout 8
- Consistency of grind
 - Adjusting the grinder 14
 - Grinder adjustment switch 8
- Contact details 48
- Cover
 - Bean container 8
 - Filler funnel for ground coffee 8
 - Water tank 8
- Cup platform 8
- Customer support 48

D

- Descaling
 - Machine 39
 - Water tank 41

- Display 9
- Display messages 42
- Disposal 44
- Double product 17
- Drip tray 8

E

- Emptying the system 44
- Energy-saving mode 27
- Errors
 - Troubleshooting 43
- Espresso 17

F

- Filler funnel
 - Filler funnel for ground coffee 8
- Filling
 - Bean container 10
 - Water tank 14
- Filter
 - Changing 36
 - Inserting and activating the filter 34
- Fine foam frother 8
 - Cleaning 32
 - Dismantling and rinsing 33
 - Rinsing 31
- First-time use 11
 - With filter cartridge activation 11
 - Without filter cartridge activation 12

G

- Grinder adjustment switch 8
- Ground coffee 19

H

- Height-adjustable coffee spout 8
- Hotline 48
- Hot water 21
- Hot water and steam preparation
 - Switch for hot water and steam preparation 8

I

- Important safeguards
 - Safety 4
- Instant coffee
 - Ground coffee 19
- Internet 10

- J**
 JURA
 Contact details 48
 Internet 10
- L**
 Language 29
- M**
 Machine
 Cleaning 37
 Descaling 39
 Rinsing 31
 Setting up 10
 Switching off 23
 Switching on 22
 Maintenance 30
 Daily maintenance 22
 Messages, display 42
 Milk
 Connecting milk 15
 Milk foam 19
- P**
 Permanently setting the water for the cup size 20
 Permanent settings in programming mode 24
 Power cord 8
 Preparation 16
 Cappuccino 18
 Coffee 17
 Espresso 17
 Ground coffee 19
 Hot water 21
 Milk foam 19
 Two specialty coffees 17
 Problems
 Troubleshooting 43
 Product settings 25
 Professional fine foam frother
 Dismantling and rinsing 34
 Programming mode 24
 Automatic switch-off 28
 Energy-saving mode 27
 Language 29
 Product settings 25
 Setting the water hardness 26
 Unit for amount of water 28
- R**
 Rinses
 Cappuccino frother rinsing 31
 Rinsing
 Fine foam frother 31
 Machine 31
 Rotary Switch 9
- S**
 Safety
 Important safeguards 4
 Settings
 Permanent settings in programming mode 24
 Setting up
 Setting up the machine 10
 Short operating instructions 10
 Switch for hot water and steam preparation 8
 Switching off
 Machine 23
 Switching on
 Machine 22
 Switch-off
 Automatic switch-off 28
 Symbol
 Maintenance 9
 P (programming) 9
 Steam 9
 Symbol description 3
- T**
 Technical data 45
 Tel 48
 Transport 44
 Troubleshooting 43
 Two products 17
- U**
 Unit for amount of water 28
 Use, First-time 11
- W**
 Water hardness
 Determining the water hardness 13
 Setting the water hardness 26
 Water tank 8
 Descaling 41
 Filling 14
 Website 10

11 JURA contact details / Legal information

JURA Elektroapparate AG
Kaffeeweltstrasse 10
CH-4626 Niederbuchsiten
Switzerland

	USA: JURA Inc.	Canada: FAEMA
Customer Service		
Phone	1-800-220-5701	1-(855)-544-8600
E-Mail	info@us.jura.com	info@juracanada.ca
Opening Hours (EST)	Mon – Thu 9am – 9pm Fri 9am – 8pm Sat 9am – 5pm	
Distributor Address	20 Craig Road Montvale, NJ 07645	115 Matheson Boulevard East Mississauga, Ontario, L4Z 1X8
Phone	001 (201) 767-3999	1-(905)-501-8600
Fax	001 (201) 767-9684	
Internet	www.us.jura.com	www.ca.jura.com

@ You will find additional contact details for your country at
www.jura.com.

- Technical changes** We reserve the right to make technical changes. The diagrams used in these instructions for use are for illustration purposes only and do not represent the original colors of the machine. Some details of your IMPRESSA may vary.
- Feedback** Your opinion is important to us! Use the contact link at www.jura.com.
- Copyright** The instructions for use contain information which is protected by copyright. It is not permitted to photocopy these instructions for use or translate them into another language without the prior written consent of JURA Elektroapparate AG.